

BOSTROM DRIVER'S SEAT

SEAT COVERING	SEAT MODEL		
	BOSTROM RouteMaster	BOSTROM RouteMaster + Aire	BOSTROM RouteMaster + Aire TC w/hyd. brakes
Black Vinyl Back - 4315776 Seat - 4322137	00017453	01860261	00014189
Black Vinyl/Fabric	00017454	00014177	01697754
Brown Vinyl	00017449	00014178 <i>Std Rep Seat</i>	00014192
Brown Vinyl Fire Retardant	00017450	00014179	00014193
Brown Vinyl/Fabric	00017451	00014180	01697705
Burgundy Vinyl	00017442	00002309	00002316
Burgundy Vinyl Fire Retardant	00002323	00002313	00002318
Burgundy Vinyl/Fabric	00017446	00002310	00002320
Blue Vinyl	00002322	00002315	00002317
Blue Vinyl Fire Retardant	00002331	00002314	00002319
Blue Vinyl Fabric	00002325	00002312	00002321
Kev Brown Vinyl Fab seat w/o Ped	00047616		
Brown Vinyl, w/o Ped	00035608		



**BOSTROM
RouteMaster**



**BOSTROM
RouteMaster + Aire**

SEAT COVERING	OPTIONAL ARMREST
Brown Vinyl	01697762
Brown Vinyl Fire Retardant	01697770
Burgundy Vinyl	00002326
Burgundy Vinyl Fire Retardant	00002328
Blue Vinyl	00002327
Blue Vinyl Fire Retardant	00002320
Black Vinyl	01697804

BEST PART NUMBER COMBINATIONS FOR SEAT COVERS AND FOAM

NO. 1	NO. 2	NO. 3	NO. 4 and 5
1. Blue Bird	1. Pre-DOT Lo Back	0. Seat cover	26. Seat size
2. Carpenter	2 Regular Metal Back	2. Velcro	30. Seat size
3. Superior	3. Cushion – 1 st Generation	9. Drivers	39. Seat size
4. Thomas	4. DOT Back – 1 st Generation		45. Seat size
5. Ward/Amtran	5. DOT Back – 2 nd Generation		
6. Wayne	6. Cushion – 2 nd Generation		
NO. 7 and 8			
See BES1 color chart			
NO. 9 and 10			
“ / “ used when there are two (2) colors in one cover			

NO. 6
-0. Regular
-1. White welt
-2. Black welt
-3. Matching welt

7. New York Hi-Back – 1 st Generation
8. Cushion – 3 rd Generation (AmTran)
9. New York Hi-Back – 2 nd Generation (AmTran)

EXAMPLE OF HOW PART NUMBER WORKS:

64039-011 (6) Wayne, (4) DOT Back 1st Generation, (0) Seat cover, (39) 39”, (-0) Regular, (11) Dark green

16039-212 (1) Blue Bird, (6) Cushion 2nd Generation, (0) Seat cover, (39) 39”, (-2) Black welt, (12) Green

MAKE	Break Down on Part Number Changes:	
Blue Bird	Pre-1979 = 1st Generation	1979-Present = 2nd Generation
Carpenter	All backs = 1st Generation	Pre-1985 cushion = 1st Generation 1986-Present cushion = 2nd Generation
Superior	Pre-1978 = 1st Generation	1979-Present = 2nd Generation
Thomas	Pre-1982 back = 1st Generation 1983-Present back = 2nd Generation	Pre-1977 cushion = 1st Generation 1978-Present = 2nd Generation
Ward	Pre-1993 back = 1st Generation 1993-Present back = 2nd Generation 1993-Present HB - 2nd Generation	Pre-1977 cushion = 1st Generation 1978-1993 cushion = 2nd Generation 1993-Present cushion = 3rd Generation
Wayne	Pre-1992 back = 1st Generation 1993-Present back = 2nd Generation	Pre-1980 cushion = 1st Generation 1981-Present cushion = 2nd Generation

BESI COLOR CHART

COLOR CODE	DESCRIPTION
AMTRAN / IC	
100	42 oz chocolate
106	52 oz chocolate
051	Prevail chocolate
004	52 oz Prevail chocolate
115	Kevlar chocolate
101	42 oz green
107	52 oz green
053	Prevail green
111	52 oz Prevail green
104	Kevlar green
082	42 oz grey
109	52 oz grey
077	Prevail grey
113	52 oz Prevail grey
102	Kevlar grey
040	42 oz blue
108	52 oz blue
060	Prevail blue
112	52 oz Prevail blue
072	Kevlar blue
105	42 oz black
110	52 oz black
071	Prevail black
114	52 oz Prevail black
103	Kevlar black
PRE-1998 COLORS AMTRAN	
027	Old chocolate
049	Old Kevlar chocolate
024	Old jungle green
050	Old Kevlar green
041	Space blue
025	Chestnut

COLOR CODE	DESCRIPTION
BLUE BIRD	
012	Green
015	Brown
031	Blue
079	Prevail brown
050	Kevlar green
085	Kevlar brown
006	Kevlar blue
075	Kevlar maroon
116	Maroon
117	Prevail green
118	Prevail maroon
119	Kevlar blue pigskin
121	Green pigskin
122	Prevail green pigskin
123	Blue pigskin
124	52 oz brown
126	52 oz green
125	Teal
086	Black
096	Kevlar grey new
CARPENTER	
011	Dark green
019	Persimmon
017	Elk
039	Canyon
040	Blue
073	Prevail green
081	Kevlar green
098	Prevail canyon
099	Kevlar canyon
076	52 oz canyon
060	Prevail blue
072	Kevlar blue
082	Grey

COLOR CODE	DESCRIPTION
THOMAS	
002	52 oz Grey
007	Prevail brown
014	Spanish green
028	Spanish brown
033	Blue
037	Grey
052	52 oz green
069	Prevail blue
070	Prevail green
080	Prevail grey
087	Kevlar blue
088	Kevlar grey
093	Kevlar brown
094	Kevlar green new
095	Kevlar blue new
096	Kevlar grey new
097	Kevlar brown new
WAYNE	
011	Dark green
013	Saddle tan
078	Prevail tan
083	Kevlar tan
010	Holly green
073	Prevail green
077	Prevail grey
081	Kevlar green

COLOR CODE	DESCRIPTION
MISCELLANEOUS	
036	Gillig green
026	Black
035	NC/SC brown
010	Superior holly green
042	Midbus/Collins grey
023	Beige

CLOTH	
Brown	
Blue	
Green	
Maroon	
Black	

SEAT REPAIR TAPE

3" x 60-Yard Rolls

02142925	Green
02142933	Brown
04295341	Red
08312597	Blue
08312589	Gray
08312571	Black
00029737	Burgundy



18817

Meets Federal Motor Vehicle Safety Standard (FMVSS) #302 - Flammability of Interior Materials

SEAT ATTACHING HARDWARE

00892604

01766716

- 3758810 Stud
- Gas Shock for Seat

09009750

- To, plug, removable Track Mount

00615567 *Pre-1978*

- Clamp
- Positive seat cushion
- Rear
- Used with round tube seat frames



00825331

- Clamp
- Swivel
- Positive seat cushion
- Used with round tube seat frames



00919811

- Clamp
- Positive
- DOT-TF
- Rear
- Used 1977-Present

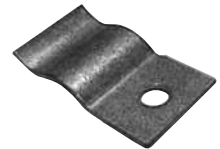

00919803

- Clamp
- Swivel
- DOT-TF
- Front
- Used 1977-Present



02001352

- Nut (4 per seat)
- 1/4 x 20



00813477

- Screw (4 per seat)
- 1/4-20 x 1/2



01458793

- Seat belt cutter



00003459

- Mounting bracket
- Seat cushion
- With US heater



10

U
P
H
O
L
S
T
E
R
Y

UPHOLSTERY

BLUE BIRD COLORS

01409226	Green (1978-98)	All Blue Bird rolls are 58" wide.	All Blue Bird rolls are 40" long.
01409184	Brown		
00000860	Burgundy		
00001763	Blue (1999-Present)		
00001767	Green (1999-Present)		
01685494	Teal		

"LOW SMOKE", ARAMID

01732072	Brown	All Aramid rolls are 58" wide.	All Aramid rolls are 40" long.
01732064	Green		
00001765	Burgundy		

SEWING THREAD

02004133	Nylon black (used with standard upholstery)
01435239	Black (used with Aramid upholstery)